

SITE PLAN
SCALE: 1" = 30'-0"

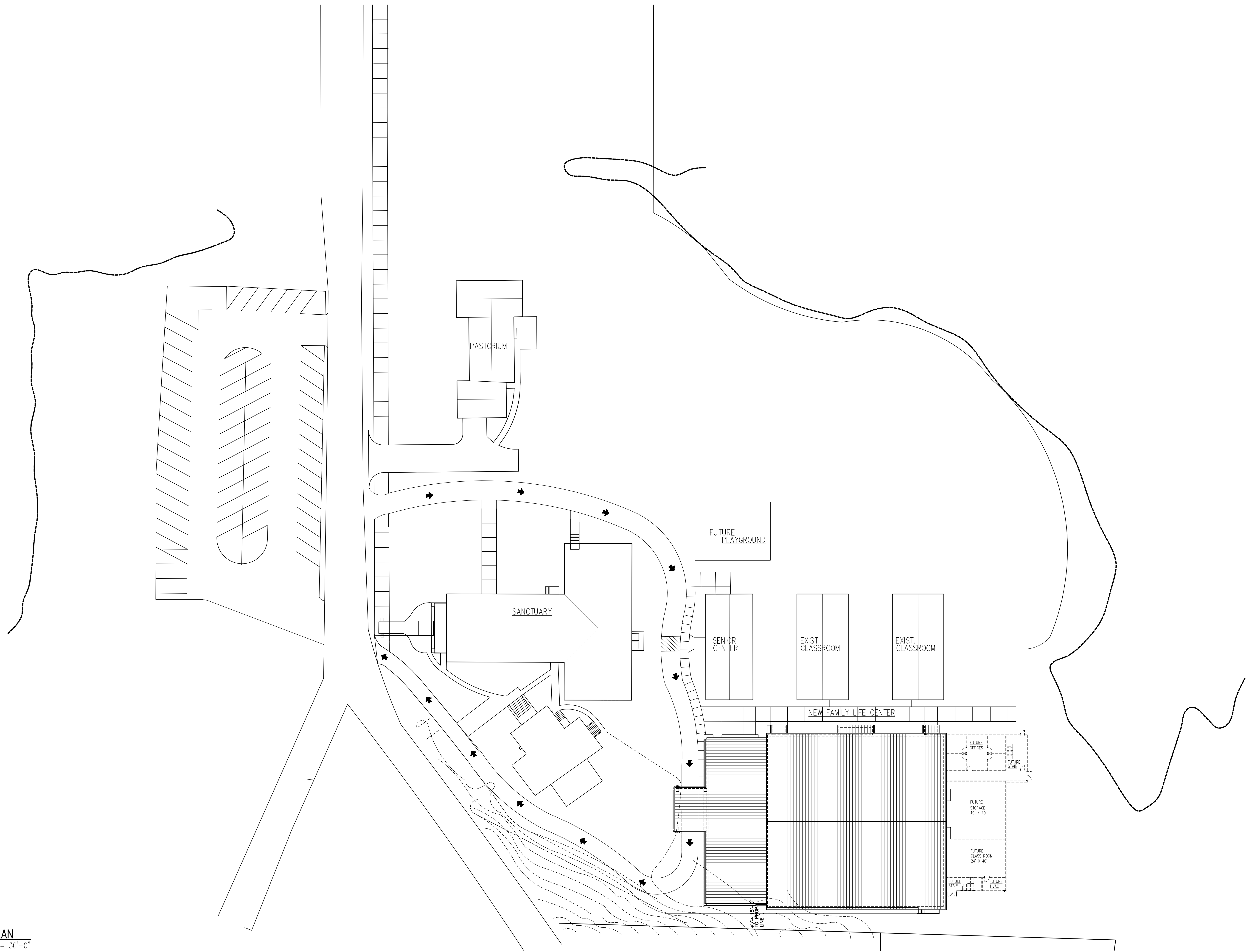

HARLEY AND ASSOCIATES
ARCHITECTS, P.C.
AIA AUGUSTA GEORGIA

A NEW
FAMILY LIFE CENTER
FOR
BATH FIRST BAPTIST CHURCH
134 SCHOOL ROAD
BATH, SOUTH CAROLINA

DATE
MONTH/DAY/YEAR
FILE
XXXX
REVISIONS

COPYRIGHT © 2006
HARLEY & ASSOCIATES, ARCHITECTS, P.C.
SHEET NO.

SITE
OF X